

Plot 9 (Floor 1)
Living/Dining/Kitchen 21'10" x 21'5" (6643 x 6535mm)
Bedroom 1 (incl Dressing) 13'11" x 10'11" (4235 x 3325mm)
En Suite 7'11" x 5'3" (2425 x 1600mm)
Bedroom 2 10'9" x 9'8" (3287 x 2955mm)
En Suite 7'10" x 4'11" (2378 x 1510mm)
Bedroom 3 13'5" x 9'0" (4101 x 2744mm)
Bathroom 7'10" x 7'5" (2380 x 2249mm)
Total Area 1423 sq ft (132.2 sq m)

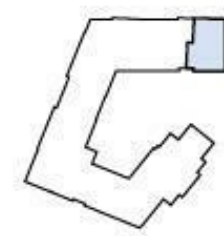

Hampstead Reach, Chandos Way NW11

A rarely available and beautifully proportioned three bedroom, three bathroom first floor apartment situated in this exclusive development in Hampstead Garden Suburb. Hampstead Reach is designed in keeping with the 'Arts & Craft' style and is centred around a beautifully maintained communal garden and offers luxury living with underground parking and daytime concierge. The development is situated conveniently for Golders Green's transport and the Hampstead Heath extension.

The accommodation comprises a large open-plan reception/kitchen/dining room with generous island/breakfast bar, master bedroom with ensuite and dressing room, two further double bedrooms (one ensuite), family bathroom, utility cupboard and private south-facing terrace. This apartment is finished to a high standard internally and benefits include; modern kitchen with Miele appliances and instant hot water tap, comfort cooling and underfloor heating.

THREE BEDROOMS; THREE BATHROOMS (TWO ENSUITE); LARGE OPEN PLAN KITCHEN/LIVING/DINING ROOM; UTILITY CUPBOARD; MIELE APPLIANCES AND INSTANT HOT WATER TAP; COMFORT COOLING; UNDERFLOOR HEATING; SOUTH-FACING PRIVATE TERRACE; UNDERGROUND PARKING; CONCIERGE; BEAUTIFULLY MANICURED COMMUNAL GARDENS

SOLE AGENT

£1,500,000

